

SITE PLAN LEGEND:

-  TREE/SHRUB
-  BUILDING ENTRANCE
-  PROPERTY LINE

Note: Property line information taken from Plan No. 8-GL-1135, Lots 106 and 107 Maitland Concession produced by D. Culbert Ltd. Ontario Land Surveyor dated September 11, 2015.

Site Statistics and Zoning Chart	
Town: GODERICH, ONTARIO	Zone: C3-12
Zone Provision	Existing
Lot Area: (min.)	232,900 ft ² (21,637 m ²)
Lot Frontage: (min.)	225' (68.6 m)
Lot Depth: (min.)	654' (199 m)
Lot Coverage: (max.)	8.5%
	19,800 ft ² (1,839.4 m ²)
Front Yard: (min.)	AS SHOWN
Rear Yard: (min.)	AS SHOWN
Exterior Side Yard: (min.)	N/A
Interior Side Yard: (min.)	AS SHOWN
Landscaped Open Space: (min.)	67%
	157,080 ft ² (14,593 m ²)
Height of Building: (max.)	EXISTING
Parking: 5 + 1/50m ²	2 Spaces Existing
1,658m ² INDUSTRIAL / 50 = 33.2	

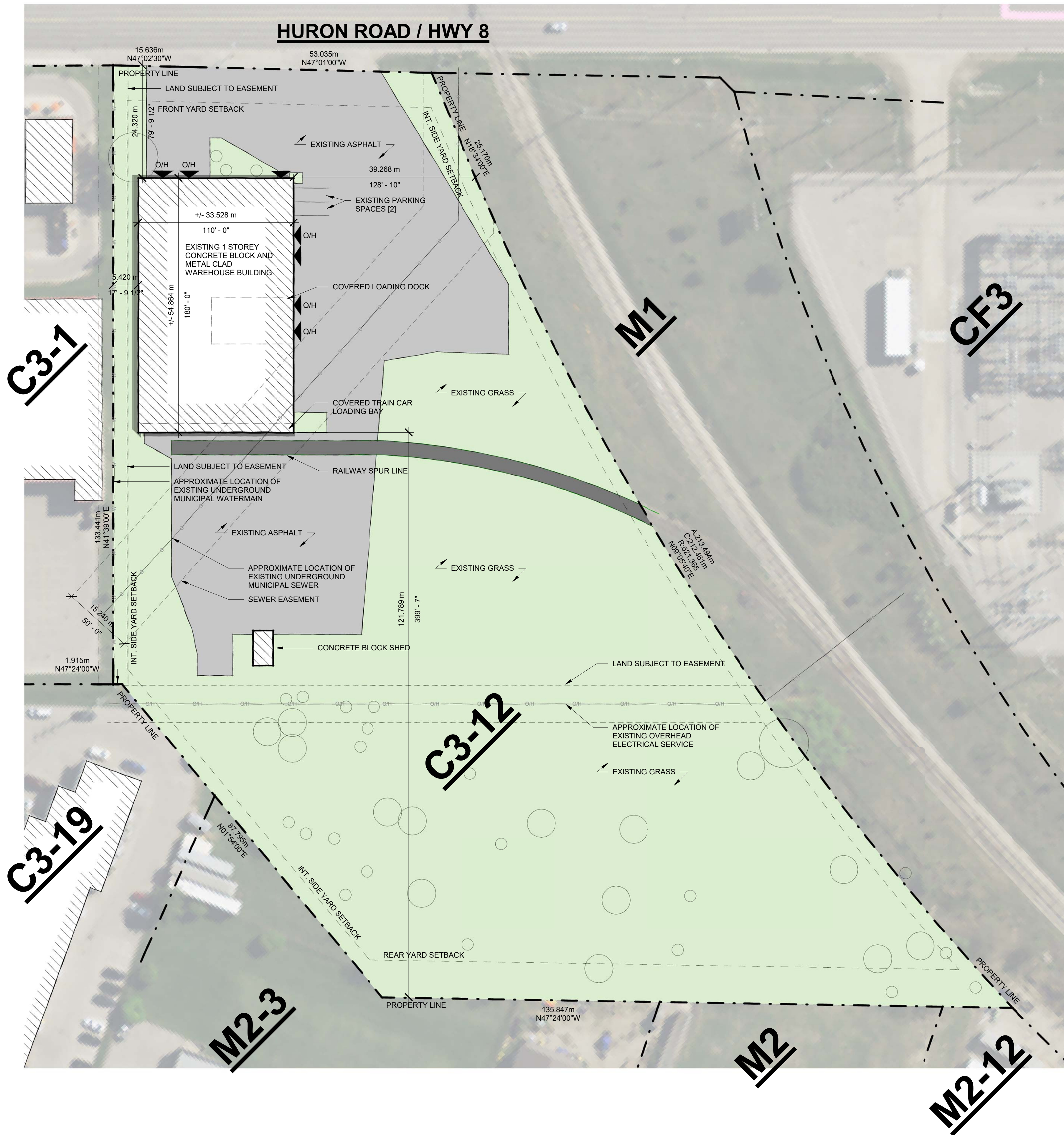

ZONING BY-LAW AMENDMENT SITE PLAN

436 Huron Road
Goderich, Ontario

Allan Avis architects inc.

60 West Street, Goderich, Ontario, N7A 2K3
www.allanavisarchitects.com

